

SPRING LOCK COPING, 1/4" SLOPE

SPLICE PLATES 6" WIDE

20 GA. GALV. STEEL CLIP  
PRE-PUNCHED 12" WIDE, 40" O.C.

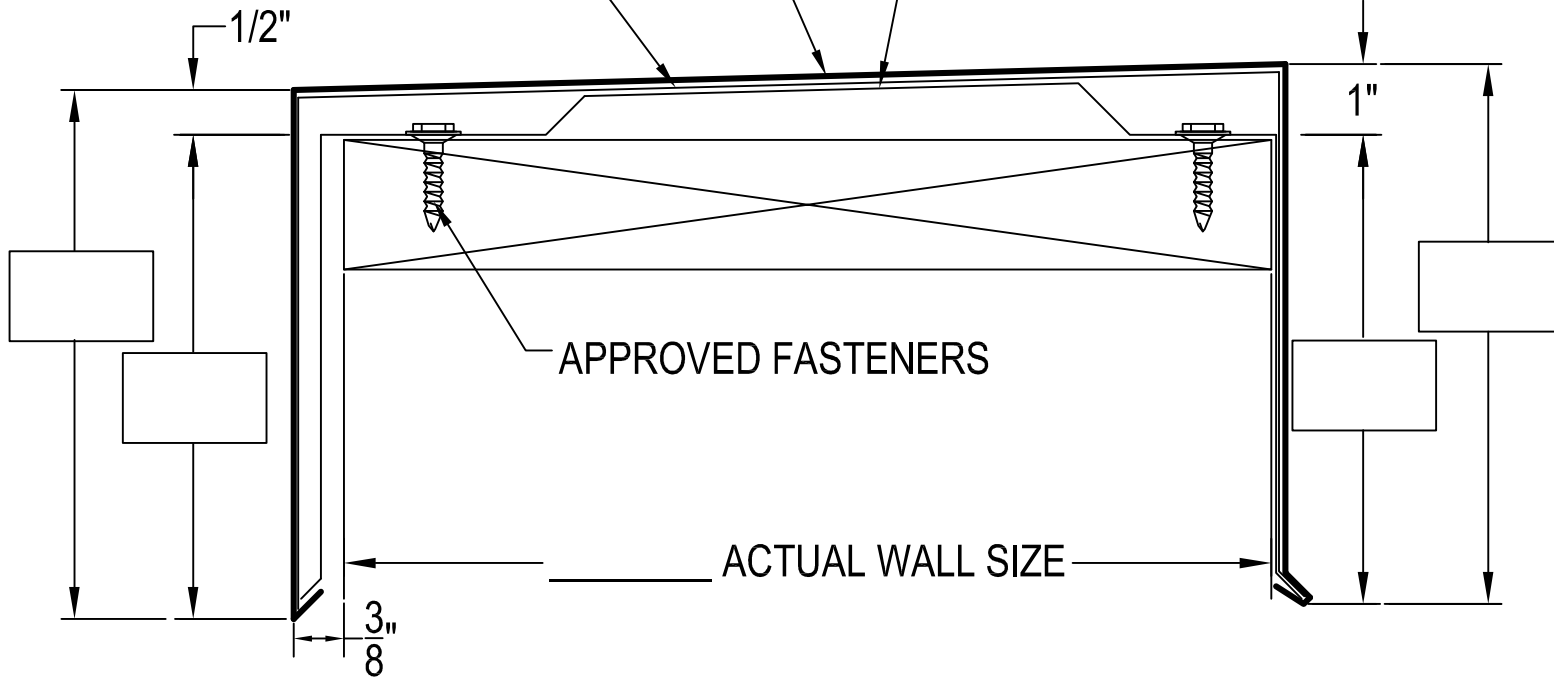

COPING TO BE FABRICATED 3/8" LARGER THAN WALL SIZE  
FOR WALL VARIATION AND TO FACILITATE INSTALLATION

METAL TYPE

.032 ALUM. KYNAR 500	
.040 ALUM. KYNAR 500	
.050 ALUM. KYNAR 500	
.063 ALUM. KYNAR 500	
.032 ALUM. B/E	
.040 ALUM. B/E	
24GA. KYNAR 500	
22GA. KYNAR 500	
16OZ COPPER	
20OZ COPPER	
26GA STAINLESS	
OTHER	

COLOR

QUANTITIES:

TOTAL LFT (10' SECTIONS)

UNDER PLATES

MITER

HIDE-FAST SL

TSM PROGRAM (OFFICE USE ONLY):

CUSTOMER

JOB NAME

JOB ADDRESS

CONTACT #

APPROVAL

NOTE: CONTRACTOR OR INSTALLER IS RESPONSIBLE FOR FIELD  
VERIFICATION & QUANTITIES BEFORE FABRICATION.

**TSM**

**TRI-STATE  
METALS**

— LLC —

41 N. LAWN AVE  
ELMSFORD, NY 10523  
914-347-8157