

TSM Fascia EC System

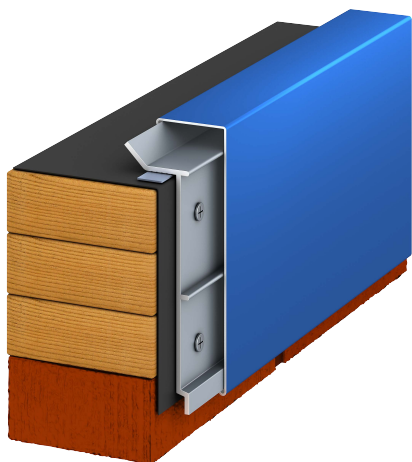

Overview

The TSM Fascia EC System is a two-part assembly that includes a continuous cleat and a decorative fascia cover for single-ply commercial roof systems. Our Fascia EC is available in pre-painted Kynar500® .032" formed aluminum as well as 24 gauge Galvalume steel. This product features an .080 extruded aluminum pre-punched cleat with fasteners spaced at 12" on center. All products come in standard 10' standard fascia and 12' extruded cleat lengths. Concealed splice plates and fasteners are included with the purchase of this product.

Features and Benefits

- ★ Secures roof Membrane to Parapet Wall
- ★ Allows for the use of high-torque screws without penetrating the top surface of the Membrane
- ★ Pre-Punched Continuous Extruded Cleat that allows for quicker install
- ★ Staggered face cover and cleat laps offer additional water protection
- ★ Stock Sizes for quick delivery
- ★ ANSI-SPRI ES-1 Certified
- ★ 210 MPH Lifetime Wind Warranty
- ★ Corporate and Custom Colors are available
- ★ Mill Finished Aluminum and Clear Anodized available
- ★ 35-YR Gold Standard Transferrable Paint Warranty

41 North Lawn Ave / Elmsford, NY 10523
 Ph. 914-347-8157
 Fax 914-347-8191
 web: www.tsmny.com
 email: sales@tsmny.com

Installation

For complete installation instructions, please refer to Tri-State Architectural specifications and details.

REVIEW CURRENT TRI-STATE ARCHITECTURAL SPECIFICATION AND DETAILS FOR SPECIFIC INSTALLATION REQUIREMENTS.

Quality Assurance

TSM Drip Edge System is tested per ANSI/SPRI Test Method RE-2 for fascia. The Fascia EC system shall be certified by TriState to design pressures as indicated in current edition of SPRI's Wind Resistance Standard for Edge Systems used with Low Slope Roofing System. This product meets International Building Code minimum requirement.

Technical Services

Engineering and shop drawings, as well as long-form specifications and CAD details, are available from Tri-State. Product samples, detail sheets, color chips and color charts are also available for submittal packages. For personal assistance with questions or for full submittals, contact Tri-State Metals or your local independent sales representative.

TSM Fascia EC Specifications with .080 Extruded Cleat

Material	Face	Sustained Pressures
24 gauge	up to 8-1/2"	-300 psf (*)
0.040 AL	up to 8-1/2"	-340 psf (*)
0.032 AL	up to 8-1/2"	-430 psf (*)

* Design Engineer must apply the Factor of Safety
 **ADDITIONAL GAUGES - .050 and .063 aluminum and 22 gauge Galvalume are available upon request



Our Shop is Your Shop!