

HIDE-FAST SL 16

ANSI
SPRI
ANSI/ SPRI ES-1 TESTED

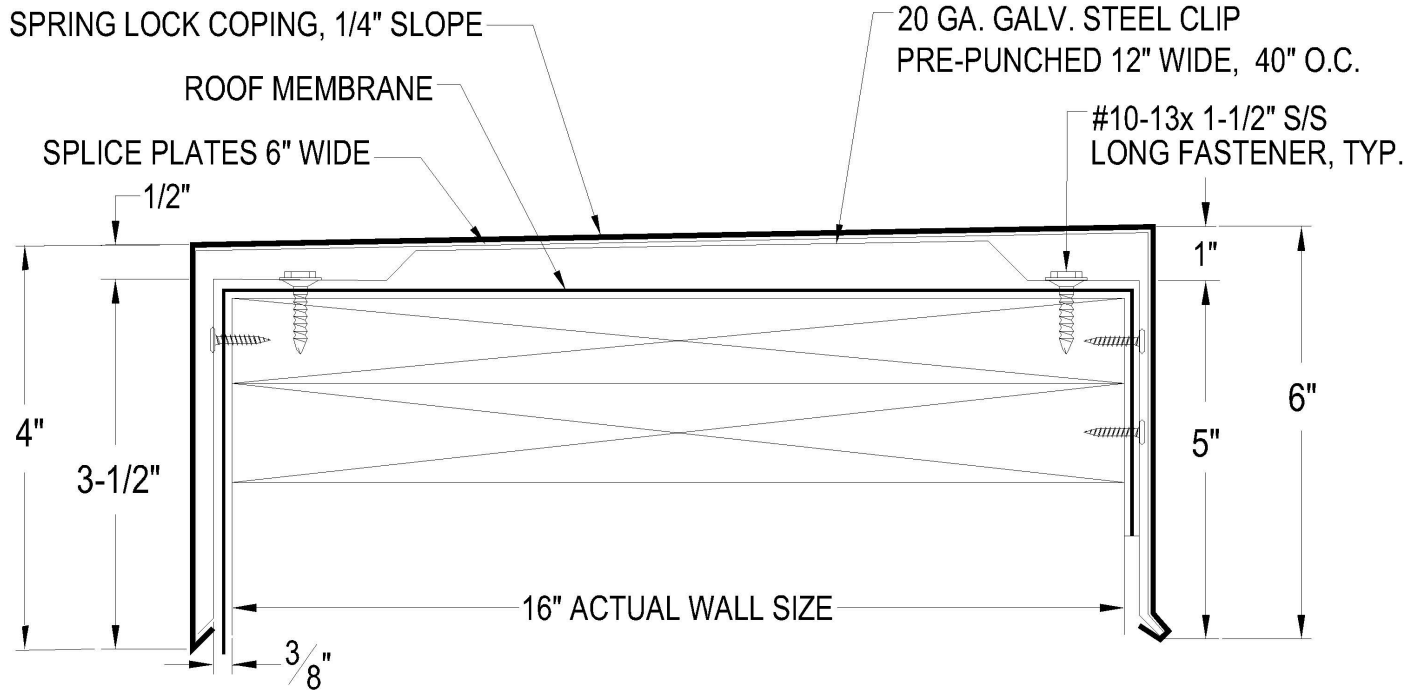

CLIP TO BE FABRICATED 3/8" LARGER THAN WALL SIZE
FOR WALL VARIATION AND TO FACILITATE INSTALLATION

- Continuous Cleat and fasteners provided.
- Concealed Splice Plates provided.
- Splice Plate Sealant available for extra charge.

PRINT APPROVAL:

Architect and/or Contractor shall verify all dimensions, sizes, and quantities, All products to be installed in strict accordance with TSM's printed instructions.

Approved By: _____

Date: _____

QUANTITIES:

Lineal Feet (10'-0" Lengths): _____

Outside Miters**: _____ ☐ Optional Welded (Surcharge Applies)

Inside Miters**: _____ ☐ Optional Welded (Surcharge Applies)

Right End Caps**: _____ ☐ Optional Welded (Surcharge Applies)

Left End Caps**: _____ ☐ Optional Welded (Surcharge Applies)

Splice Plate Tape Sealant: ☐ Optional Sealant (Surcharge Applies)

** Standard riveted

PROJECT: _____

ARCHITECT: _____

ROOFING CONTRACTOR: _____

REPRESENTATIVE: _____



41 North Lawn Ave / Elmsford, NY 10523
Ph. 914-347-8157
Fax 914-347-8191
web: www.tsmny.com
email: sales@tsmny.com

MATERIAL:

☐ 24GA ☐ .040" AL

☐ Other: _____

Finish: _____

Color: _____

Effective Date: 5-1-13

Drawn By: B.Z.M.

Approved By: R.A.