



FASCIA EC PRINT APPROVAL

ANSI-SPRI ES-1 CERTIFIED

.032" Aluminum = 430 psf,

.040" Aluminum = 340 psf, 24GA Steel = 300 psf

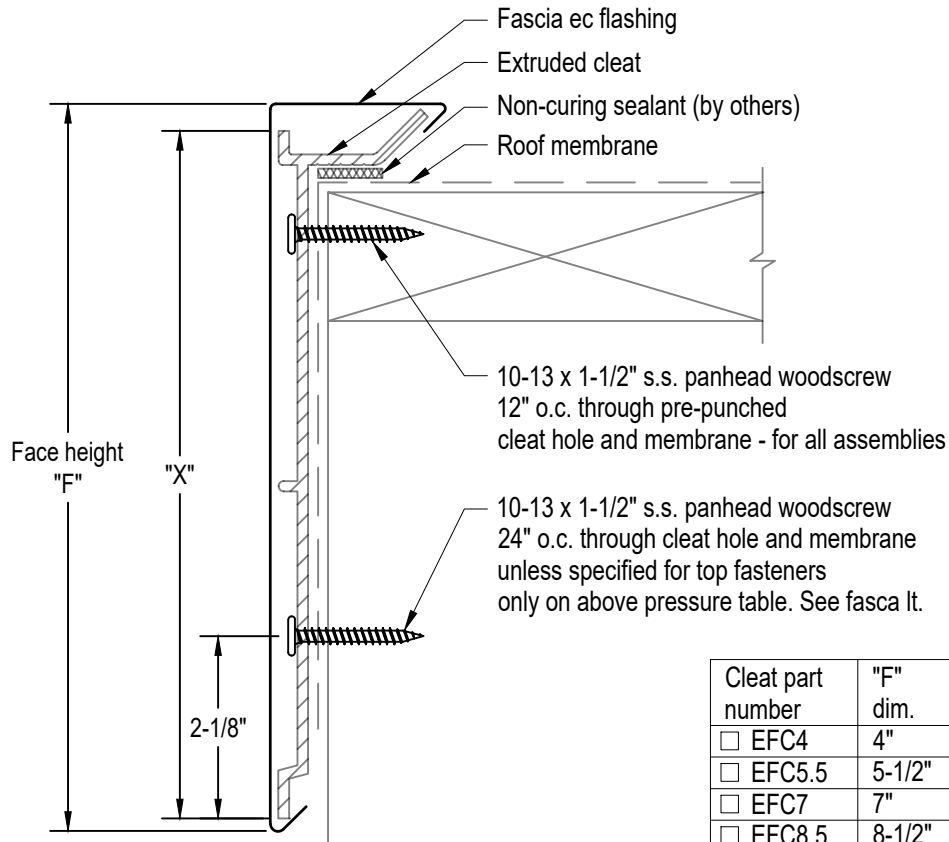

Cleat part number	"F" dim.	"X" dim.	Nailers covered
<input type="checkbox"/> EFC4	4"	3-1/4"	1
<input type="checkbox"/> EFC5.5	5-1/2"	4-3/4"	2
<input type="checkbox"/> EFC7	7"	6-1/4"	3
<input type="checkbox"/> EFC8.5	8-1/2"	7-3/4"	4

MATERIAL

24GA Steel

Color: _____

22GA Steel

Finish: _____

.040" Aluminum

.050" Aluminum

.063" Aluminum

Other: _____

QUANTITIES

Linear Feet (10'-0" Lengths): _____

*Outside Miters: _____

*Inside Miters: _____

Right End Caps: _____

Left End Caps: _____

* Standard Riveted

PROJECT DETAILS

Project Name: _____

Architect: _____

Roofing Contractor: _____

Representative: _____

PRINT APPROVAL

Effective Date: _____

Approved By: _____