

Installation Guide



Our Shop is Your Shop!

41 North Lawn Ave / Elmsford, NY
10523 Ph. 914-347-8157
Fax 914-347-8191
web: www.tsmny.com
email: sales@tsmny.com

Assembly Overview:

Econo Coping LT Installation Guide

This guide is provided to assist you in the installation process. Additional assistance is available by calling us!

Contents:

Assembly Overview	1
Step 1: Installing 22ga Galv. Cleat	2
Step 2: Installing Miters	2
Step 3: Installing Straight Lengths	3
Step 4: Installing End Caps/Terms	3
Detail: Econo Coping LT	4

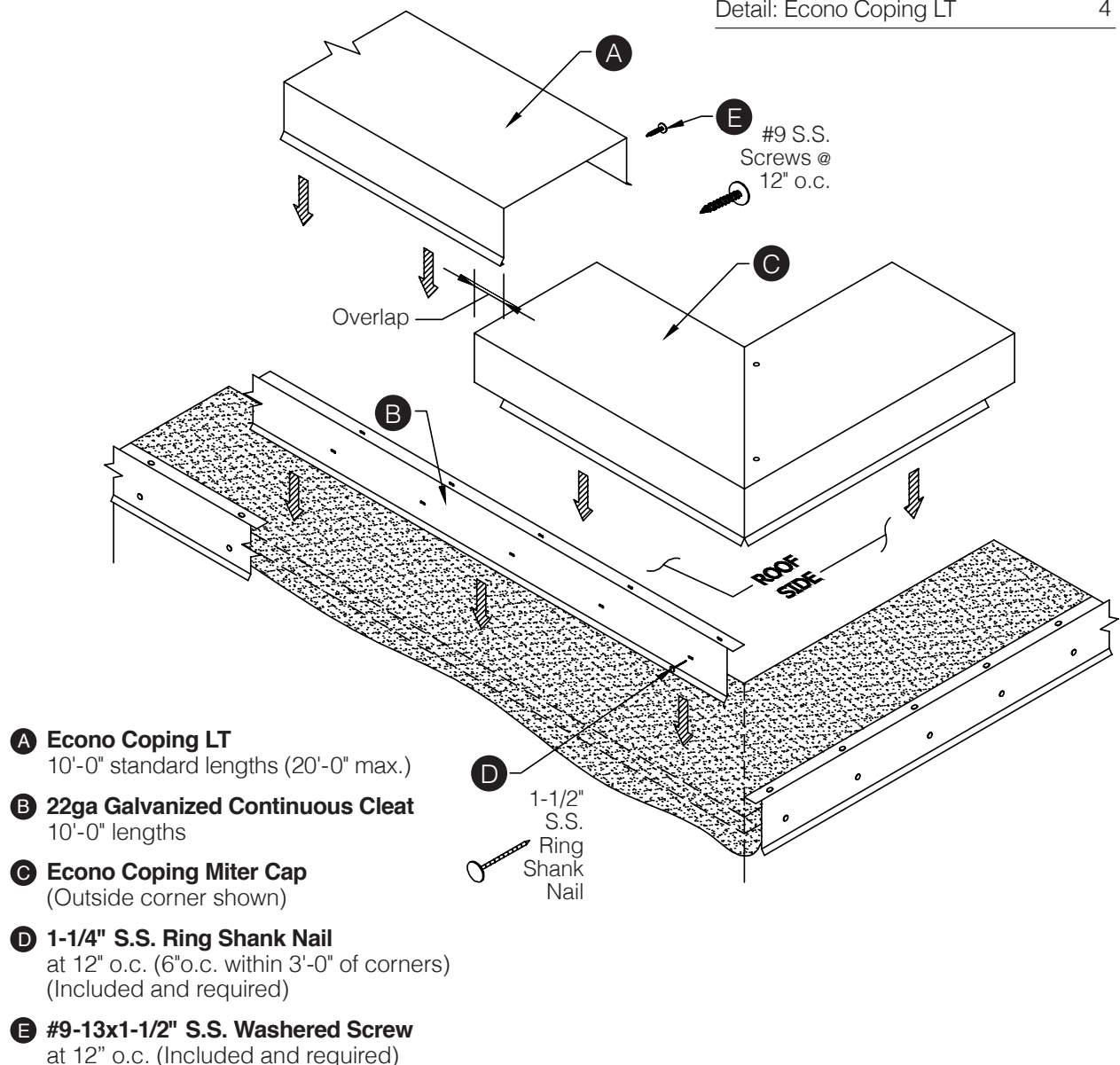

Installation: Econo Coping LT

Step 1: Installing 22ga Galvanized Cleave

- Prior to installing the Cleave, ensure that all metal components have been isolated from ACO treated lumber with appropriate membrane material.
- Butt Cleaves together at corner conditions.
- Install Cleave working away from corners.
- Allow 1/8" gap between sections for thermal movement.
- Attach the Cleave using 1-1/4" S.S. Ring Shank Nails provided, into each pre-punched hole.
- When within 3'-0" of corners, attach Cleave with 1-1/4" S.S. Ring Shank Nails at 6" on center.

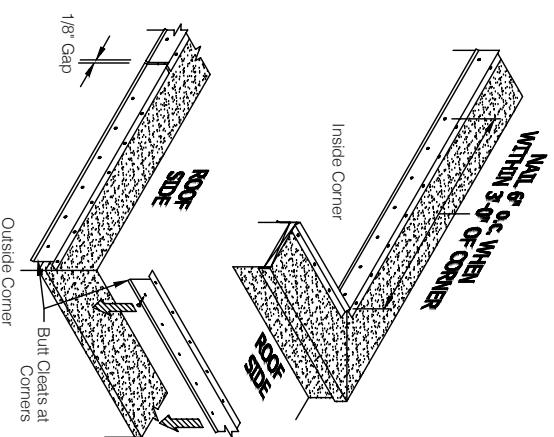

Step 2: Installing Econo Coping Miters

- Locate the Miter for the appropriate corner.
- Notch both sides of the Miter, as shown.
- Hook the drip of the Miter over the knockout of the face side of the Cleave, then rotate the Miter over the top of the parapet and screw the roof side leg of the Miter with #9-13x1-1/2" S.S. Washered Screws provided, at 12" on center.

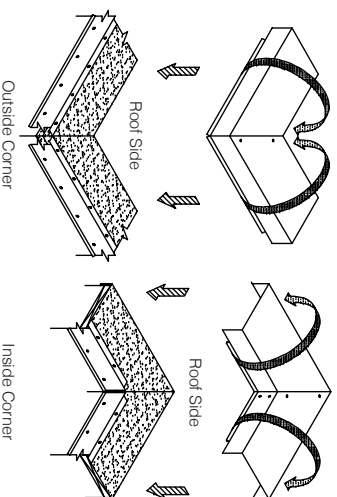

Installation Guide



Our Shop is Your Shop! email: sales@tsmny.com

41 North Lawn Ave / Elmsford, NY

10523 Ph. 914-347-8157

Fax 914-347-8191

web: www.tsmny.com

Step 3: Installing Econo Coping Straight Lengths

- Start by notching the end of the Coping opposite of the installed Miter.
- Install the Coping by hooking the drip over the knockout on the Cleave and rotating the Coping over the parapet wall and screw the roof side leg of the Coping with #9-13x1-1/2" S.S. Washered Screws provided at 12" on center.
- Consider lengths of all straight pieces prior to cutting to avoid creating relatively short sections adjacent to one another.

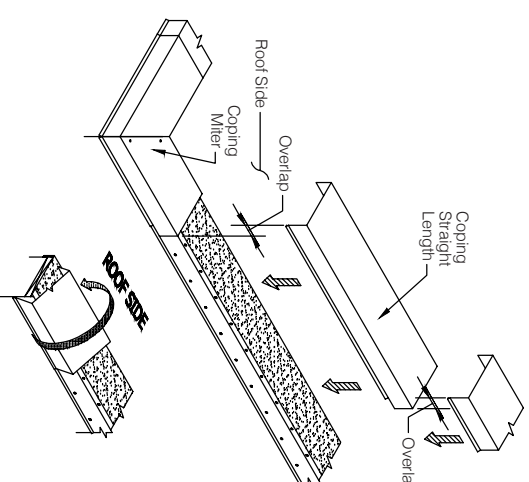

Step 4: Installing Econo Coping End Caps/Terms

- Pop-rivet the End Cap and End Term inserts into place.
- Install End Caps and End Terms by hooking the drip over the knockout on the Cleave and rotating over the part over the parapet.
- End Caps and End Terms must be restrained from moving by securing with a minimum of (2) #9-13x1-1/2" S.S. Washered Screws through the roof side leg.

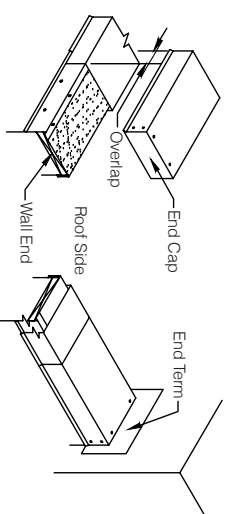

Typical Notch Procedure

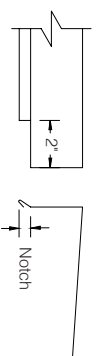

Econo Coping LT

Detail: Econo Coping LT – performance series

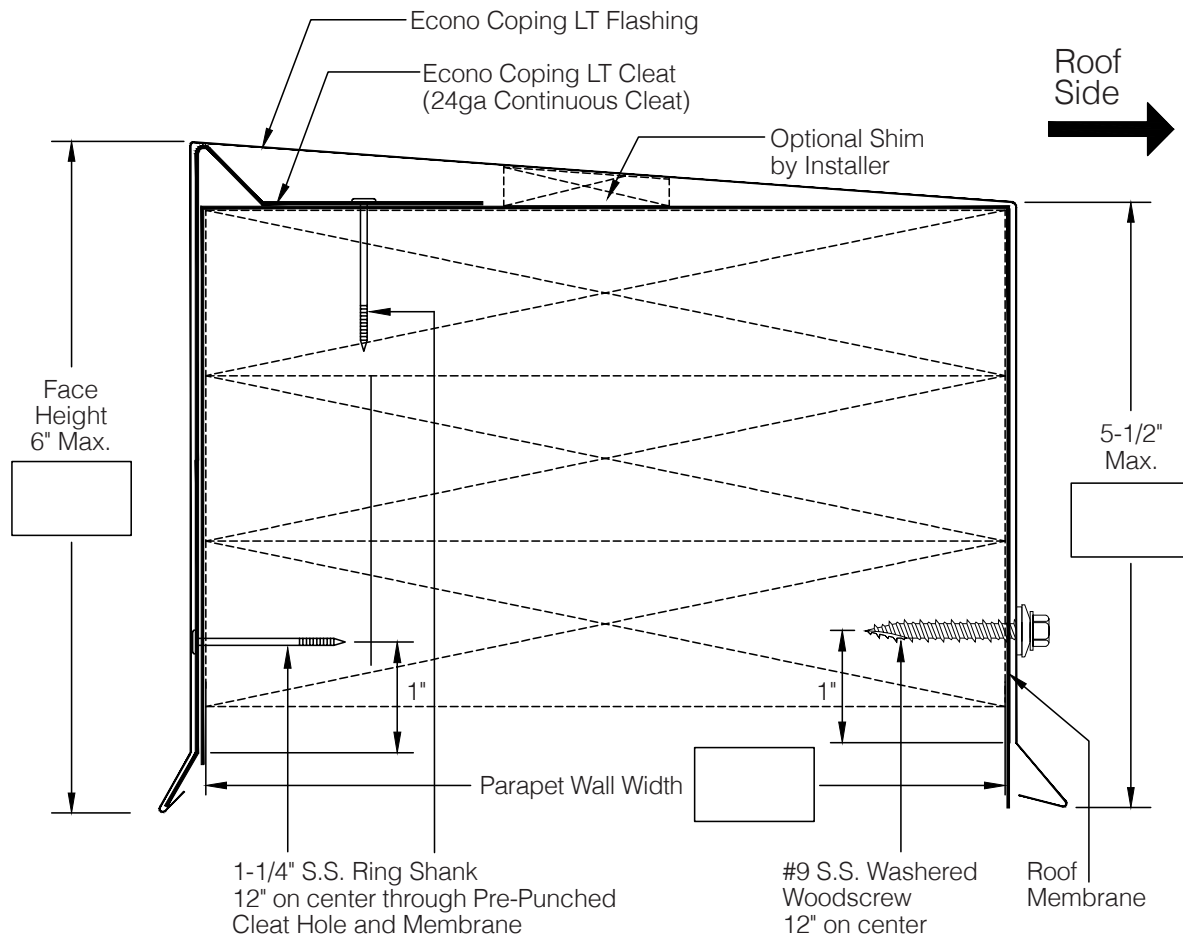

Notes:

1. Isolate all metal parts from ACQ treated wood or other galvanically incompatible material with appropriate membrane material.
2. Appliance attachments, such as lightning rods, signs, or antennae that penetrate the water seal, induce a galvanic reaction, or otherwise compromise the effectiveness of the roof edge system, shall be eliminated or isolated to prevent problems per section 8.0 if ANSI/SPRI ES-1. Appliances should also be isolated from, or not attached to, the roof edge system. Consult the lightning protection system manufacturer for specific attachment instructions.



Our Shop is Your Shop!

41 North Lawn Ave / Elmsford, NY
10523 Ph. 914-347-8157
Fax 914-347-8191

web: www.tsmny.com
email: sales@tsmny.com